

CLEVER CARDBOARD CREATIONS

### The following is Added to the package:

- Instructions for building the kitchen
- Concrete hooks (if you have ordered an extractor)
- Don't sit signs. We advise to place this on the products!

### We advise you to have the following tools when installing the kitchen:

- Cutting knife
- Stairs and hammer (when installing an extractor)
- Transparent tape

### For the best result:

- The kitchen is built easiest when the user manual is followed step by step 1
- Ensure that the boxes are stable on the floor
- For pipes and sockets cut the recesses for the obstacles on the wall from the back of the boxes.
- The hanging parts are hung by means of concrete hooks
- For a corner kitchen: start building up from the corner!

The kitchen can be used on 2 sides! The individual countertops are made by using velcro rounds attached to the lower cupboard.

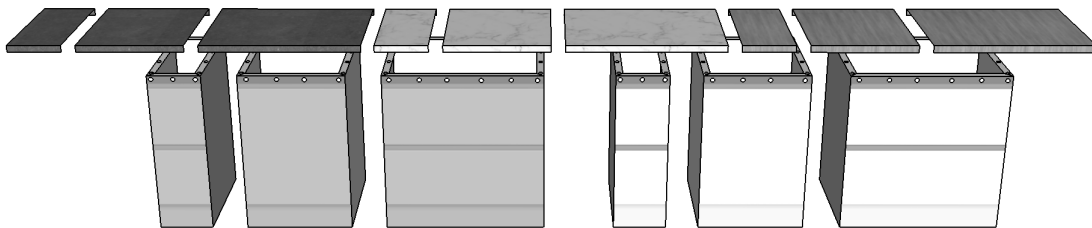

## LOWER CUPBOARD 30CM-60CM – 90CM WIDE

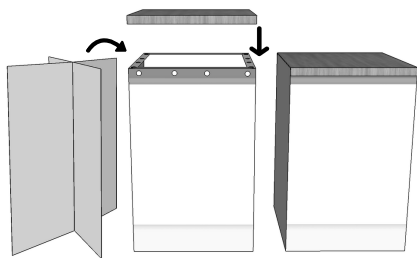

Required boxes:  
1 bottom  
1 worktop  
1 reinforcement cross

### Description:

- Unfold the box and fold the edges at the bottom inwards.
- Slide the two plates into a cross and place inside the box (through the topside).
- Fold the edges at the topside inwards
- Place the worktop by means of the velcro rounds on the box.
- Press the velcro rounds firmly on all sides.

## SUGGESTION FOR HIGH CABINET 60CM WIDE

Required boxes:  
2 x bottom (60x60x94)  
2 x reinforcement cross  
1 x panel oven

### Description:

- **Lower part;** unfold 1 box and fold the edges at the bottom inwards.
- Slide the two plates into a cross and place inside the box (through the topside).
- Fold the edges at the topside inwards
- **Upper part:** the upper box needs no cross. Fold the edges on topside and bottom inwards.
- Place the box upside down on the lower cupboard.
- We recommend removing the velcro rounds. Stick the loose panel with the oven image over the two boxes. The handle list of the bottom box must remain visible.

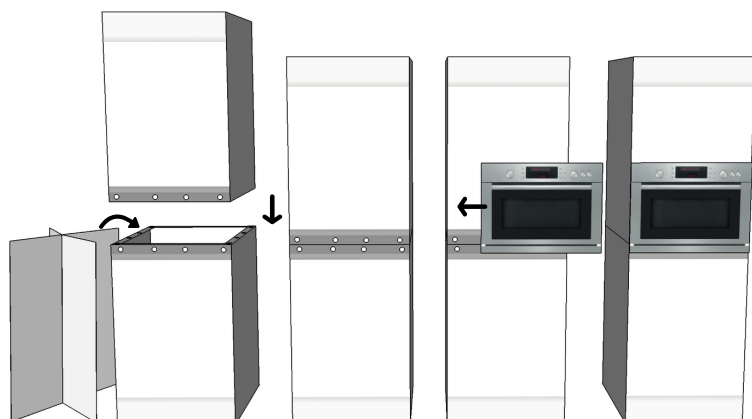

### CORNER CABINET

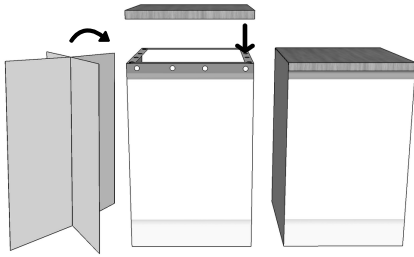

Required boxes:  
1 bottom (60x60x94)  
1 worktop 60 cm wide  
1 reinforcement cross

#### Description:

- The 60 cm wide lower cupboard can be used as a corner cabinet!
- Unfold the box and fold the edges at the bottom inwards.
- Slide the two plates into a cross and place inside the box (through the topside).
- Fold the edges at the topside inwards
- Place the worktop by means of the velcro rounds on the box.
- Press the velcro rounds firmly on all sides.

### BUILDING THE KITCHEN

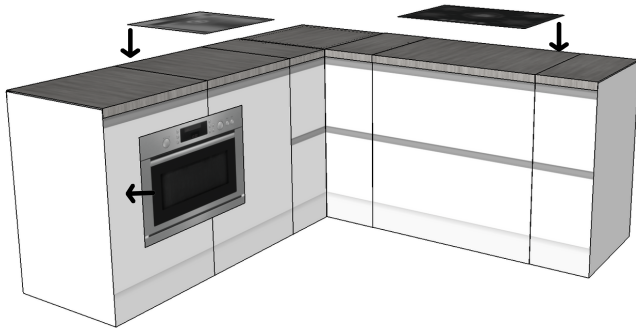

#### Description:

- Place all cabinets in the correct position
- Cut out the recesses for the pipes etc. from the back of the boxes.
- If desired, you can stick the bottom cabinets together (with a transparent tape). To do this, open the front/side of the worktop and stick the transparent tape over the two base units.
- Place the panels for equipment at the desired position by using the double-sided tape.

### EXTRACTOR

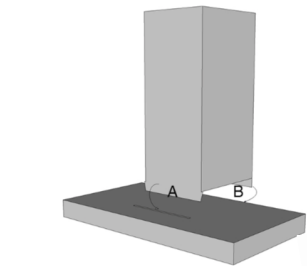

Required boxes:  
1 box shaft  
1 flat box bottom  
2 concrete hooks

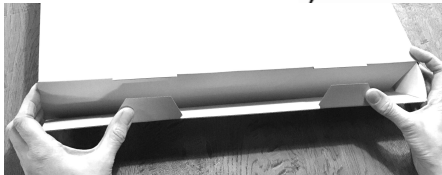

#### Description:

- Unfold both boxes (do not close yet !!)
- Slide flap A into the slot. Barbs must be pressed into the slot for fixation.
- From the inside of the flat box, remove the tape cover from flap A and press the flap on the inside for fixation.
- Fold and close the flat box; fold the upper flap and side flap inwards, guide the round flap on the inside, then insert the 2 tabs and press firmly.
- Then stick flap B on the back of the flat box. **Small notches on the back of the flat box indicate the position!**
- Suspend by means of the supplied concrete hooks and the recess on the back.
- **For positioning the extractor; see the tip below!**

### POSITIONING EXTRACTOR



#### Description:

- Keep 60 cm in between the worktop and the extractor. To determine this distance and to ensure that the object hangs straight, place a 60 cm box flat on the worktop.
- Place the extractor on top.
- Mark on the wall where the concrete hooks should be.
- Place the concrete hook with the plastic part against the wall and hit (with a hammer) the 3 nails in the wall
- The extractor can be suspended by sliding the recess on the back over the 2 hooks.

Building the Extractor:

<https://www.youtube.com/watch?v=-dFL-q-Y2MA>