

CLEVER CARDBOARD CREATIONS

The following is included:

Instructions for assembling the kitchen; Concrete hooks (if you ordered a extractor); Clips Clips (if you plan to place multiple base cabinets side by side)

We recommend having on hand:

Stanley knife; Step stool and hammer (for hanging the extractor); Transparent tape

for the best result:

- The kitchen is easiest to assemble when the instructions are followed step by step!
- Make sure the boxes are stable on the floor.
- Cut-outs for pipes, sockets, etc., can be made from the (cutting) boxes.
- Wall-mounted parts are hung using concrete hooks.
- For a corner kitchen, start assembling from the corner.
- The kitchen can be used from both sides!

60CM - 90CM

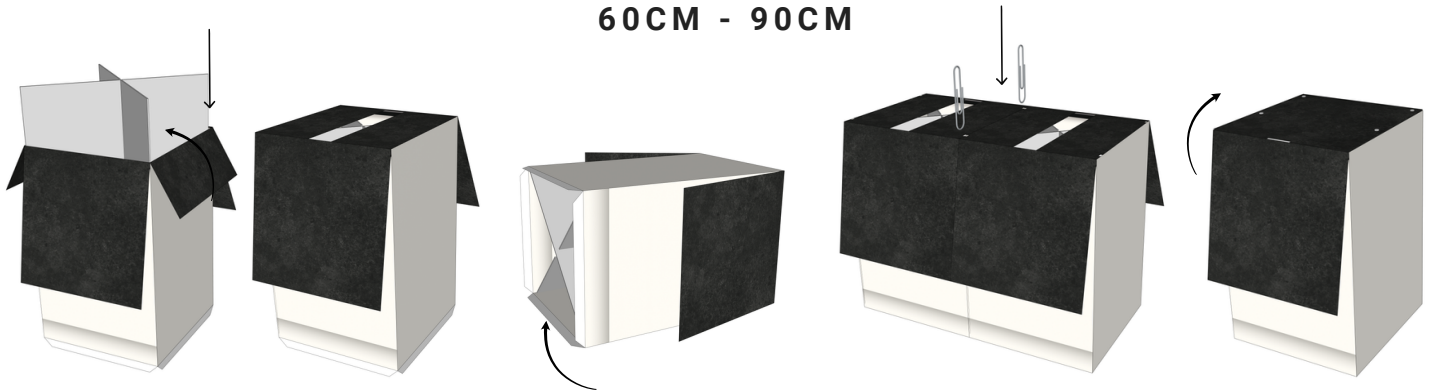

- Open the box and insert the interlocking cross from the top. Fold the side panels inward.
- Lay the cabinet on its side and fold the bottom edges tightly inward so that the cabinet is flat and stable.
- When placing multiple cabinets side by side, use the cut-outs in the side panels to secure the cabinets together with a clip.
- Fold down the back worktop. Attach the velcro circles and close the front panel, pressing it backward so the worktop fits tightly.

HIGH CABINET 60CM

Attention! Use the side without the worktop view at the front.



• Lower Part:

- Assemble the base cabinet according to the instructions for the low cabinet above, without using the velcro closure.

• Upper Part:

- Assemble the second cabinet in the same way.
- Place this cabinet upside down on top of the lower cabinet.
- Ensure the narrow top and bottom edges are folded tightly.
- Attach an appliance to the cabinet if desired.

When placing multiple cabinets side by side:
Use the cut-outs in the side panels to secure the cabinets together with a clip (see assembly instructions for 60 cm/90 cm cabinets above).

CORNER CABINET

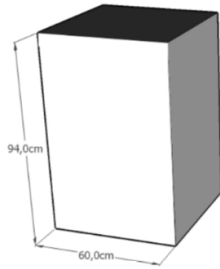

- Open the box and insert the interlocking cross from the top. Close the box using the insertion tabs.
- Attach the worktop panel to the top of the box using the velcro circles. (This can also be done later, in the next step.)

BUILDING THE KITCHEN

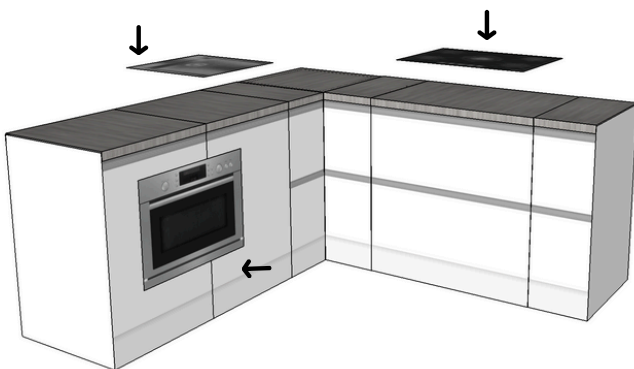

- Place all cabinets in their correct positions.
- Cut out openings for pipes, cables, etc., from the back of the (cutting) boxes.
- If desired, you can secure the lower cabinets together using clips (see lower cabinet assembly).
- Attach the panels for appliances in the desired position using double-sided tape.

EXTRACTOR

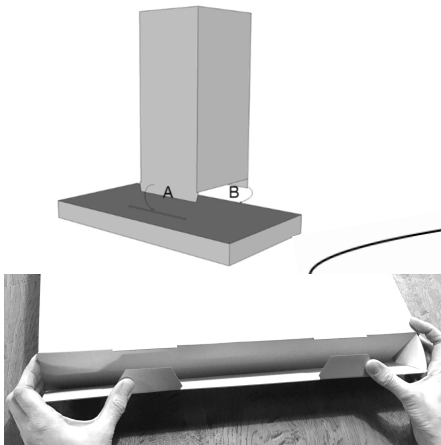

- Unfold both boxes (do not close yet !!)
- Slide flap A into the slot. Barbs must be pressed into the slot for fixation.
- From the inside of the flat box, remove the tape cover from flap A and press the flap on the inside for fixation.
- Fold and close the flat box; fold the upper flap and side flap inwards, guide the round flap on the inside, then insert the 2 tabs and press firmly.
- Then stick flap B on the back of the flat box. Small notches on the back of the flat box indicate the position!
- Suspend by means of the supplied concrete hooks and the recess on the back.
- For positioning the extractor; see the tip below!

POSITIONING EXTRACTOR



- Keep 60 cm in between the worktop and the extractor. To determine this distance and to ensure that the object hangs straight, place a 60 cm box flat on the worktop.
- Place the extractor on top.
- Mark on the wall where the concrete hooks should be.
- Place the concrete hook with the plastic part against the wall and hit (with a hammer) the 3 nails in the wall
- The extractor can be suspended by sliding the recess on the back over the 2 hooks.

<https://www.youtube.com/watch?v=-dFL-q-Y2MA>